

## CERTIFICATION

This torque wrench, as calibrated at the factory, is certified to meet the accuracy in specifications: ASME B107.14-2004, GGG-W-686, Type 2, Class A Style 1, 2 and ISO 6789. Additionally, all wrenches are calibrated on a torque standard traceable to the National Institute of Standards and Technology (N.I.S.T.). HYTORC is an ISO 17025 accredited business.

## CONVERSION TABLE

FROM	TO	MULTIPLY BY:
lb.in.	oz.in.	16
lb.in.	lb.ft.	.08333
lb.in.	kg.cm.	1.1519
lb.in.	kg.m.	.011519
lb.in.	Nm	.113
lb.in.	dNm	1.13
lb.ft.	kg.m.	.1382
lb.ft.	Nm	1.356
Nm	dNm	10
Nm	kg.cm.	10.2
Nm	kg.m.	.102
oz.in.	lb.in.	.0625
lb.ft.	lb.in.	12
kg.cm.	lb.in.	.8680
kg.m.	lb.in.	86.80
Nm	lb.in.	8.85
dNm	lb.in.	.885
kg.m.	lb.ft.	7.233
N.m	lb.ft.	.7376
dNm	Nm	.10
kg.cm.	Nm	.09807
kg.m.	Nm	9.807

## FOR YOUR PERMANENT FILE

### WRENCH

Model Number

Serial Number

## IMPORTANT ENVIRONMENTAL NOTES



PLEASE RECYCLE

This equipment may contain hazardous materials which can be harmful to the environment. Do not dispose of this equipment as municipal waste. Return it to the distributor or a designated collection center.

## LIMITED WARRANTY

The HYTORC Clicker Wrench is backed by a one year warranty. This warranty covers manufacturer defects and workmanship. The warranty excludes misuse, abuse and normal wear and tear. Exclusion is not allowed in some states and may not apply. This warranty gives you specific legal rights, and you may have other rights, which vary from state to state.

## HYTORC WORLD HEADQUARTERS

333 Route 17 North, Mahwah, NJ 07430  
+201-512-9500 • 800-FOR-HYTORC



THE HYTORC UNIVERSE IS MADE UP OF OVER 1,000 TRAINED BOLTING SPECIALISTS TO SUPPORT YOUR BOLTING NEEDS IN OVER 100 COUNTRIES.

LOCATE YOUR NEAREST HYTORC REPRESENTATIVE:

[HYTORC.COM/WORLD](http://HYTORC.COM/WORLD)

**NOTICE OF PROPRIETARY RIGHTS:** HYTORC Division UNEX Corporation ("HYTORC") is the owner of all content included in this document and all right, title and interest to such content shall remain with HYTORC. **COPYRIGHT NOTICE:** © 2021 HYTORC. Any unauthorized use or distribution of any material from this document, without HYTORC's written permission, is strictly prohibited. **TRADEMARK NOTICE:** This document contains numerous registered trademarks and servicemarks of HYTORC in the U.S. and other countries. **PATENT NOTICE:** Products in this document are covered by numerous registered and/or pending patents in the U.S. and other countries.

# HYTORC

## Quick Start Guide



## Clicker Wrench

Basic Operations Manual  
Metric

333 Route 17 N.  
Mahwah, NJ 07430  
USA

800-FOR-HYTORC  
(800-367-4986)  
201-512-9500

[hytorc.com](http://hytorc.com)

## SAFETY MESSAGES



**WARNING!** Read all safety warnings designated by the -symbol and all instructions.

### SAVE ALL WARNINGS AND INSTRUCTIONS FOR FUTURE REFERENCE.

- An out of calibration torque wrench can cause part or tool breakage
- Periodic re-calibration is necessary to maintain accuracy
- Do not exceed rated torque as overtorquing can cause wrench or part failure
- Do not use torque instrument to break fasteners loose
- Do not use cheater extension on the handle to apply torque.
- Broken or slipping tools can cause injury.



**CAUTION - RATCHET HEAD!** Ratchet mechanism may slip or break if dirty, mismatched; if worn parts are used; or if direction lever is not fully engaged. Ratchets that slip or break can cause injury.

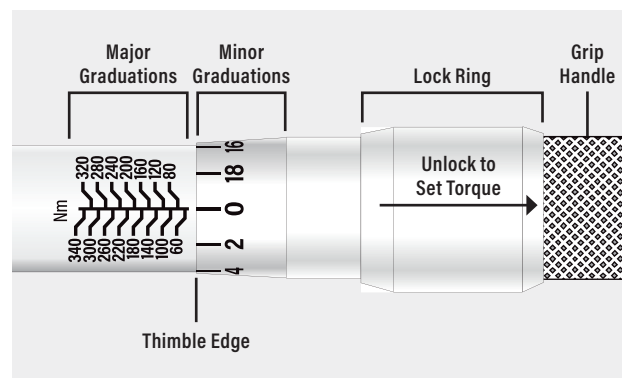


All users and bystanders should always wear safety goggles.

## MAINTENANCE AND SERVICE

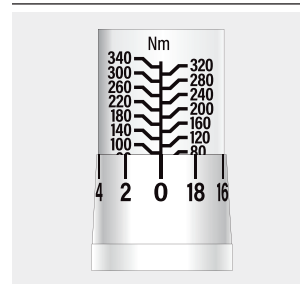
1. The torque wrench's internal mechanism is permanently lubricated during assembly. **Do not attempt to lubricate the internal mechanism.**
2. Clean torque wrench by wiping. Do not immerse.
3. Store torque wrench in protective case at its lowest torque setting. **Do not force handle below lowest setting.**
4. For more information or support, please call your local HYTORC Representative or 1-800-FOR-HYTORC (1-800-367-4986), or please visit us at HYTORC.com.

## ADJUSTMENT OF TORQUE SETTINGS

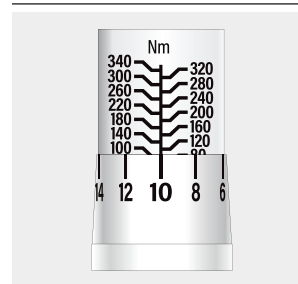


- To unlock the handle, hold tube and pull lock ring back, allowing handle to turn clockwise (CW) or counter-clockwise (CCW).
- Set wrench to desired torque as follows:  
EXAMPLE: 100 Nm
  1. Keep slight rearward pull on lock ring during all adjustments
  2. Line up thimble edge with the "100" graduation cross line, and "0" with vertical line. Torque wrench is now set to 100 Nm (See **Figure 1**).
  3. Turn handle and set thimble graduation to "10" on vertical line. Torque wrench is now set to 110 Nm (See **Figure 2**).

**FIGURE 1**

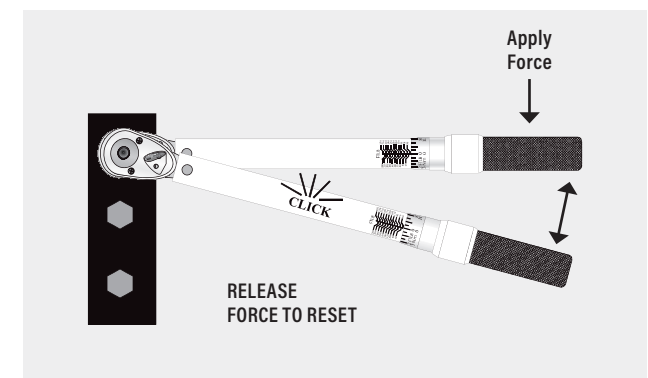


**FIGURE 2**



4. Lock handle by releasing back pressure on lock ring until it clicks and handle doesn't turn.
5. To torque fastener, keep hand centered on the grip handle. Apply a slow and steady force in the desired direction until a click/impulse is heard or felt. Stop pulling and allow the torque wrench to reset. (See **Figure 3** above right.)

**FIGURE 3**



## USE OF EXTENSIONS AND ADAPTERS

When using an extension or adapter (increasing the effective length of the torque wrench) the output torque value will change. To calculate the new torque output of the wrench, use the following formula below.

$$TW = \frac{TA \times L}{L + A}$$

- TA** Torque exerted at end of adapter  
**L** Distance between square drive and hand position  
**TW** Wrench scale reading  
**A** Length of adapter or extension

A number of variables will affect the accuracy of the above calculation:

- Length of adapter or extension
- Length of wrench
- Variations in hand position on wrench

